



RIVERLINE IS MUCH MORE THAN A PLACE TO LIVE. IT IS A SANCTUARY THAT EMBRACES THE BEST OF URBAN LIFE AND THE SERENITY OF THE RIVER, IN A PERFECT BALANCE BETWEEN MODERNITY AND NATURE.



SWIMMING  
POOL



INNER  
GARDEN



GYM



PARTY  
ROOM



RIVER  
VIEW



ARRÁBIDA  
MOUNTAIN

Every detail, from design to comfort, has been meticulously considered to create a unique and complete living experience, where exclusivity, quality of life, and simplicity converge in perfect harmony with the surroundings.









The Riverline development stands on blade-like structures rising on the horizon, creating a modern silhouette that harmonises perfectly with the natural landscape. Strategically positioned, the expansive windows offer breathtaking views of the river's deep blue and the verdant Arrábida mountains. This design floods the interiors with natural light, transforming each space into a vibrant and inviting setting.

The apartments are spacious and contemporary, designed to provide an environment that blends comfort and elegance. Materials have been rigorously selected and meticulously combined, reflecting a strong commitment to quality and design. On the façade, exclusive, handcrafted tiles create a lively texture that reacts to light and its surroundings, adding a unique touch of authenticity and beauty.

In the common areas, construction elements that preserve the memory of the industrial activity that once brought this place to life have been subtly integrated, fostering an atmosphere of history and renewal. These areas have been transformed to host modern and inviting social spaces, including a garden that embraces the enticing swimming pool – creating an oasis of tranquillity for moments of leisure and relaxation, while also inviting interaction and community.



Interior view of the condominium







Detail of the pool area





AQ1 living room view





Detail of a kitchen



Detail of a bathroom







AQ1 suite view





AQ1 dining room view



AQ3 balcony detail







AQ3 living room view





Riverline is just a short stroll from the centre of Setúbal, where the beauty of the bay unfolds at every turn. Here, history, leisure, and modernity merge into a unique atmosphere, from the emblematic São Filipe Fort and the urban beaches along the waterfront, to the bustling Luísa Todi Avenue.

The vibrant culture of the city meets the serenity of the waters and mountains, providing a privileged lifestyle where proximity to nature is a constant. With every passing day, there is an opportunity to relax and appreciate the best of Setúbal, in a refuge that combines tranquillity with incomparable beauty.

## YOUR SANCTUARY IN SETÚBAL BAY



## TRÓIA WITHIN SIGHT

Living at Riverline is also an invitation to explore the Sado River and its estuary, where water sports and entertainment combine with a natural setting that enhances everyday experiences.

Riverline is highlighted by the stunning Arrábida mountain range and the crystal-clear waters of its beaches. Its proximity to the ferry and the expansive beaches of Tróia makes this region a true paradise, ideal for those who value a connection with nature and the sea.





Riverline offers multiple options for a cosmopolitan lifestyle. You can start your day at the Livramento Market, where fresh fish and other regional products are always available. In the afternoon, you can stroll through the shops and cafés of Luísa Todi Avenue, or visit the area's art galleries and cultural spaces.

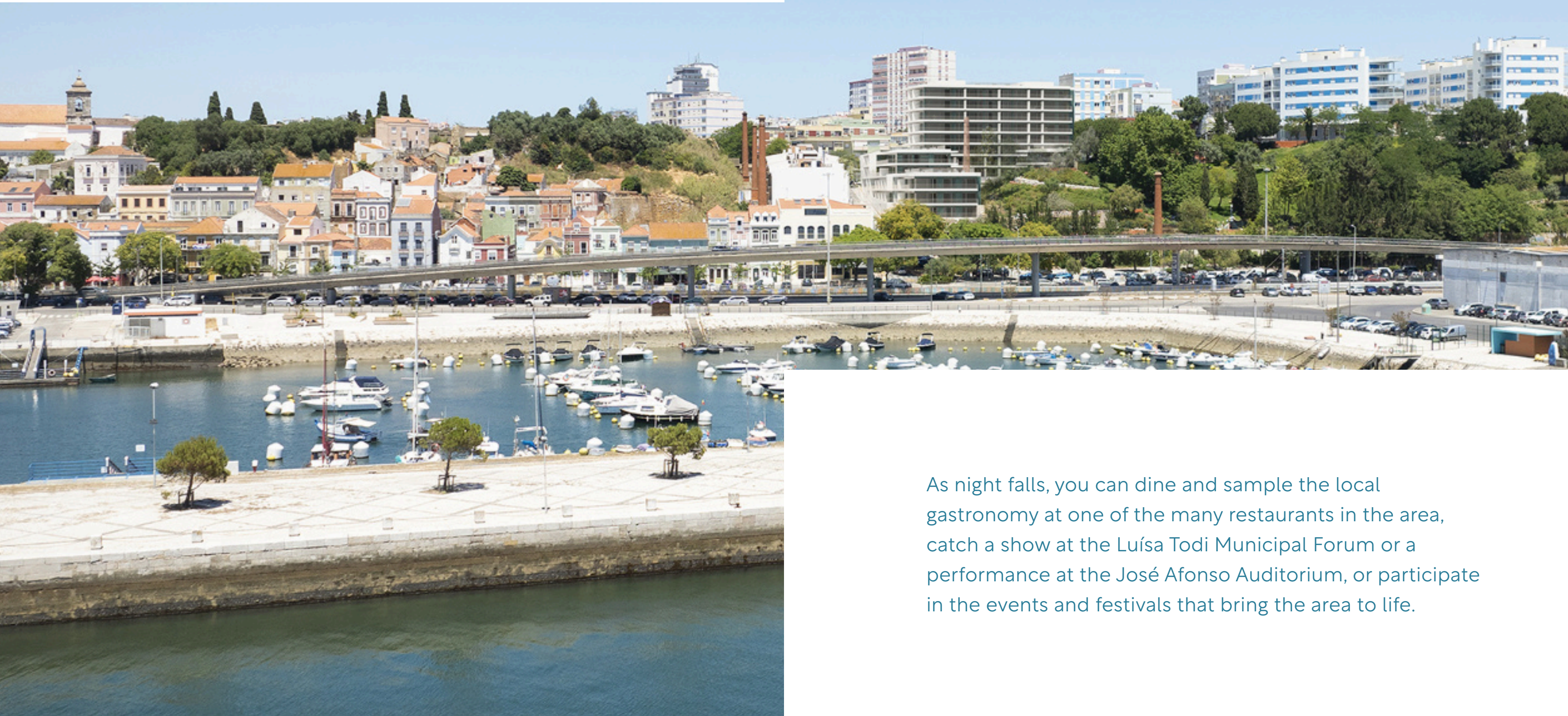

As night falls, you can dine and sample the local gastronomy at one of the many restaurants in the area, catch a show at the Luísa Todi Municipal Forum or a performance at the José Afonso Auditorium, or participate in the events and festivals that bring the area to life.



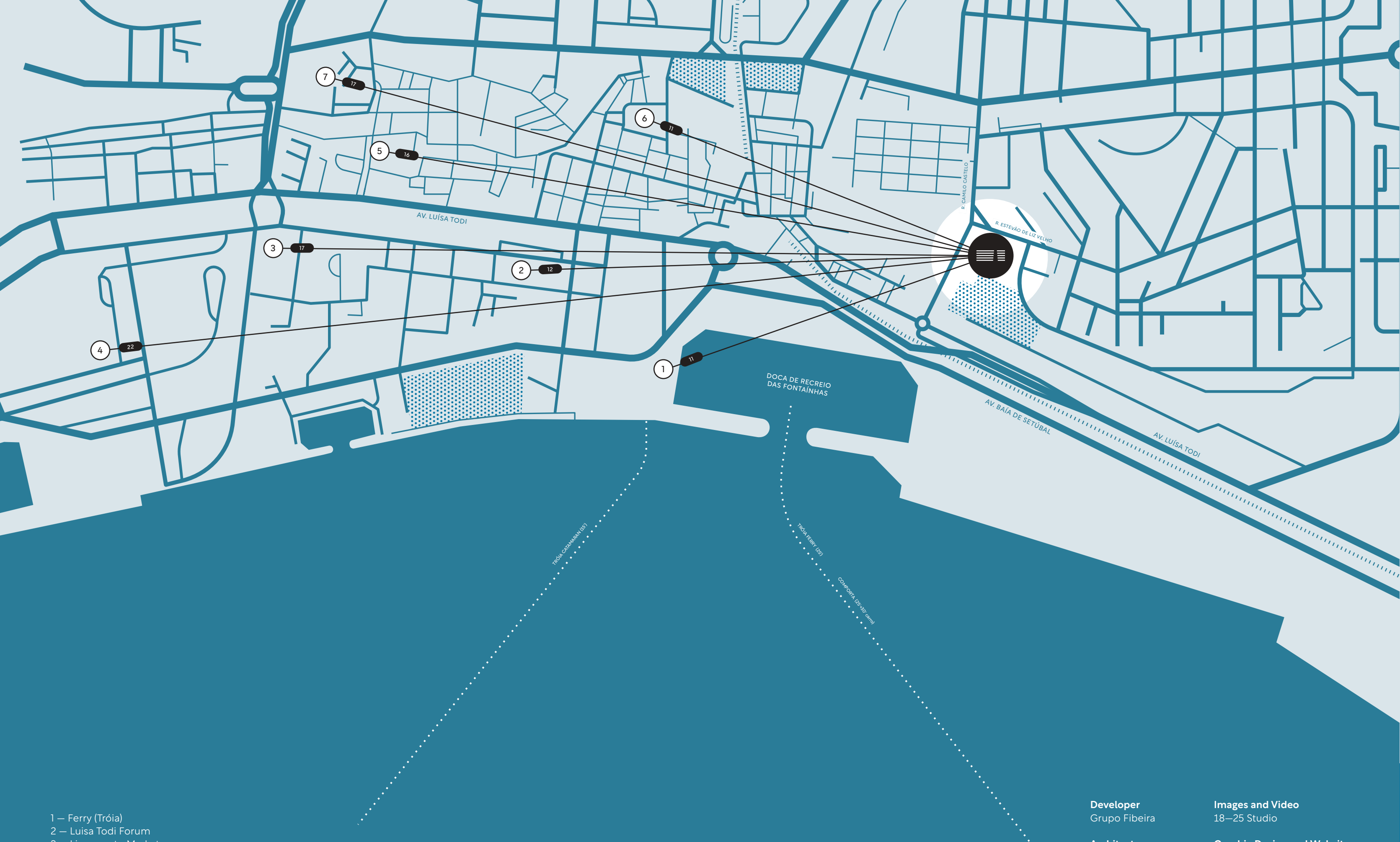

- 1 — Ferry (Tróia)
- 2 — Luisa Todi Forum
- 3 — Livramento Market
- 4 — José Afonso Auditorium
- 5 — Bocage Square
- 6 — Setúbal Cathedral
- 7 — House of Culture

# Walking distance (minutes)



**Developer**  
Grupo Fibeira

**Architecture**  
Saraiva + Associados

**Construction**  
Omatapalo

**Images and Video**  
18—25 Studio

**Graphic Design and Website**  
Speaf

[www.riverline.pt](http://www.riverline.pt)



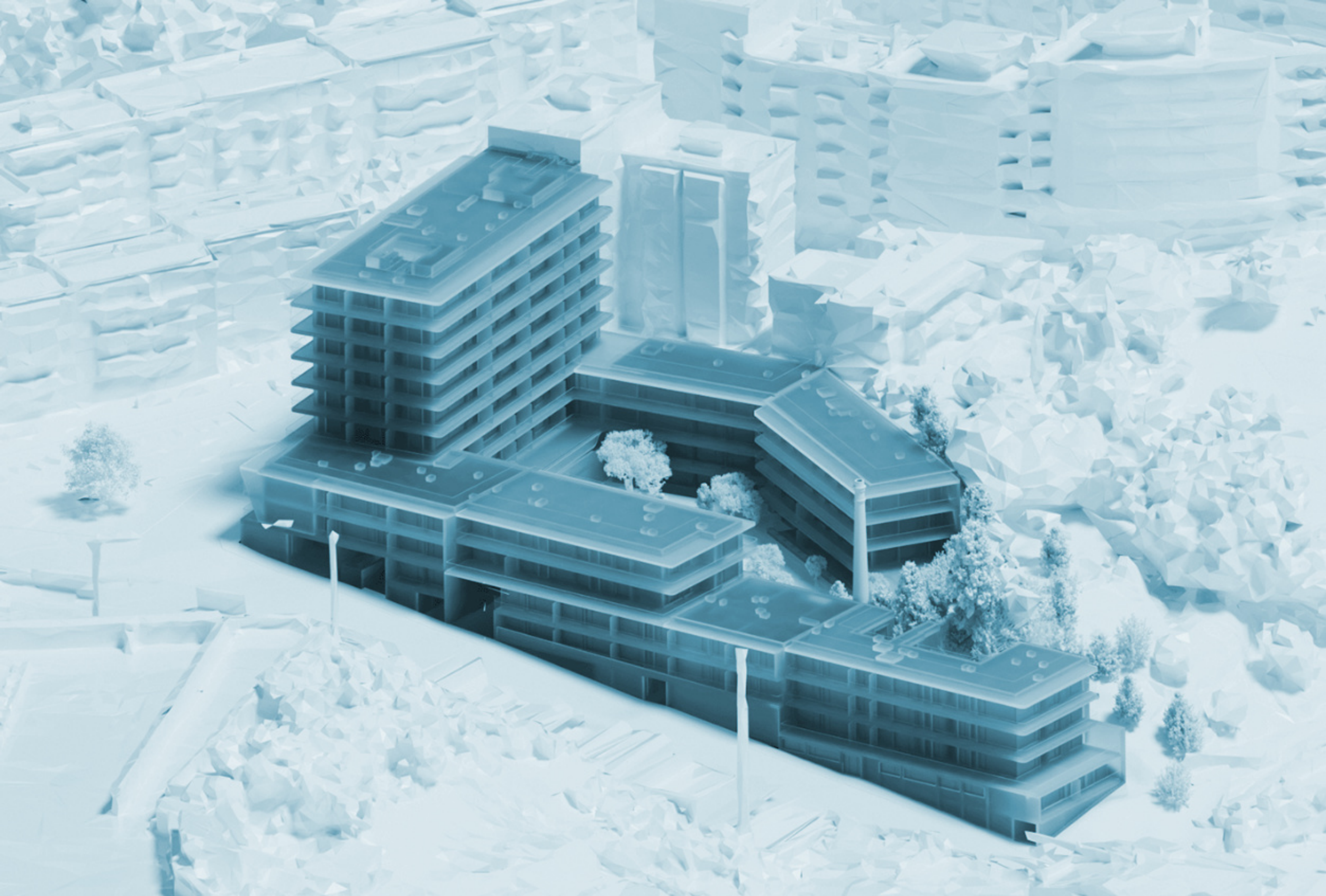





## INFORMATION AND SALES

[info@riverline.pt](mailto:info@riverline.pt)  
[+351 936 640 157](tel:+351936640157)

Rua Estevão de Liz Velho  
Rua Camilo Castelo Branco  
Setúbal — Portugal

[www.riverline.pt](http://www.riverline.pt)